

**M/s. Yuvasakthi**  
(Implementing Agency - Andaman Coir Cluster)

Tender No: SFURTI-II/ANDAMAN/ELE-01/2022-23 dated 25.08.2022

**Tender for the Electrification Works of the Common Facility Centre (CFC) of Andaman Coir Cluster**

**CORRIGENDUM-2 dated 20.09.2022**

Due to receipt of limited number of bids, the last date and time for submission of tender documents for the above tender which was originally scheduled on 14.09.2022 at 11.00 AM is now extended up to 28.09.2022 at 11.00 AM and the sealed tenders will be opened at 11.30 AM on the same day at the office of M/s.Yuvasakthi, Opp. Old Airport Gate, Near K & M Academy, 3rd floor, Dairy farm, Junglighat (Post), Port Blair, South Andaman – 744 103.

Based on the queries received through mail/letters, the following amendments are issued in the tender schedule:

S.No	Page No	Clause No.	Existing Clause				Revised Clause			
			Sl.No.	Job Description	Qty	Unit	Sl.No.	Job Description	Qty	Unit
1.	14	Annexure – I Technical Specification (S.No-17)	17	Supplying, installation, testing and commissioning of safe earthing electro type-39,80mm dia, length 2 mtrs (short time current - 52.6 rms for 1 sec, peak-125.6) with back fill compound as required.	5	Mtrs	17	Supplying, installation, testing and commissioning of safe earthing electro type-39,80mm dia, length 2 mtrs (short time current - 52.6 rms for 1 sec, peak-125.6) with back fill compound as required.	5	<b>SET</b>
			17	Supplying, installation, testing and commissioning of safe earthing electro type-39,80mm dia, length 2 mtrs (short time current - 52.6 rms for 1 sec, peak-125.6) with back fill compound as required.	5	Mtrs	17	Supplying, installation, testing and commissioning of safe earthing electro type-39,80mm dia, length 2 mtrs (short time current - 52.6 rms for 1 sec, peak-125.6) with back fill compound as required.	5	<b>SET</b>

<b>S.No</b>	<b>Page No</b>	<b>Clause No.</b>	<b>Existing Clause</b>	<b>Revised Clause</b>
3.	-	Technical Specification	(Add)	Electrical drawing given in the Annexure

**SECRETARY**

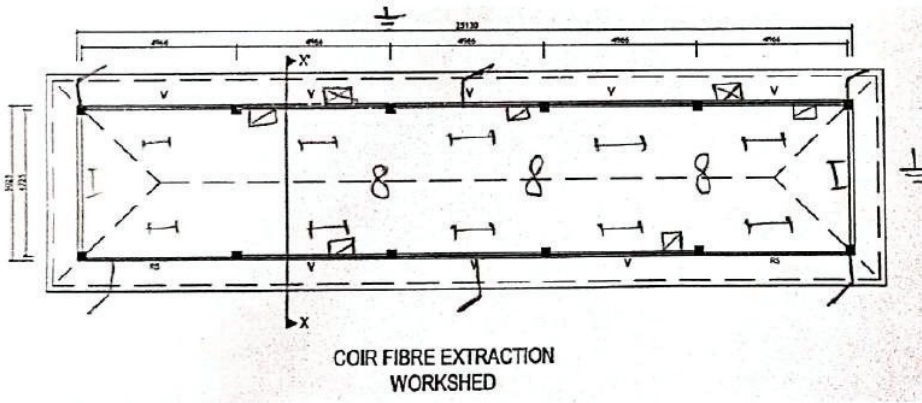

ELECTRICAL SPECIFICATION

- ① Ceiling Fan - 8
- ② LED Battan - 1
- ③ DB 4way - □
- ④ Exhaust Fan - □
- ⑤ Earthing - ⊥
- ⑥ Street Light - ⌂

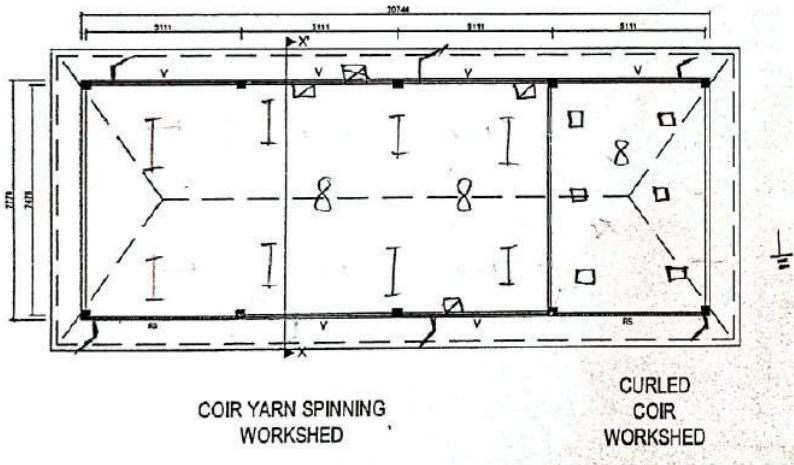

ELECTRICAL SPECIFICATION

- ① Ceiling Fan - 8
- ② LED Battan - 1
- ③ LED Square Panel Light - □
- ④ Exhaust Fan - □
- ⑤ DB 4way - □
- ⑥ Street Light - ⌂
- ⑦ Earthing - ⊥

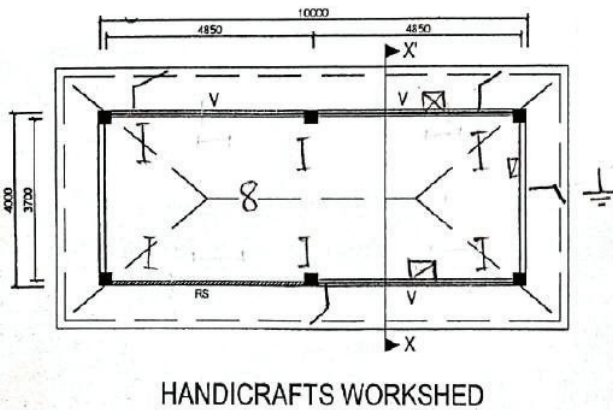

ELECTRICAL SPECIFICATION

- ① Ceiling Fan - 8
- ② LED Battan - 1
- ③ DB 4way - □
- ④ Exhaust Fan - □
- ⑤ Earthing - ⊥
- ⑥ Street light - ⌂

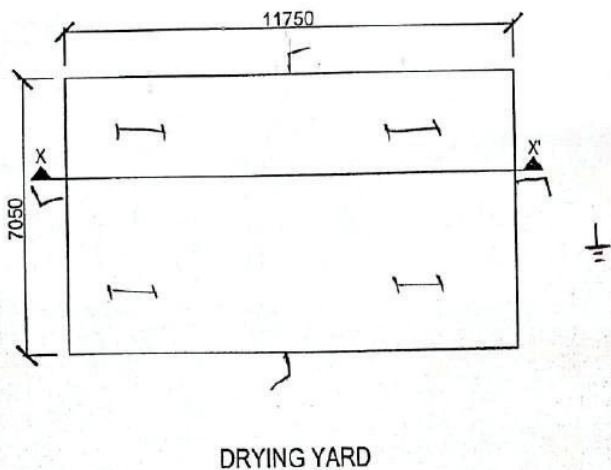

ELECTRICAL SPECIFICATION

- ① LED Battan - 1
- ② Street light - ⌂
- ③ Earthing - ⊥